

Key And Keyway Dimensions ASME B18.25.1M

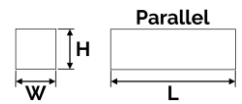

Nominal Shaft Diameter		Nominal Key Size		Keyway							
				Width			Height				Corner Radius
Over	To (Including)	Width, W Square And Rectangular	Height, H Square And Rectangular	Normal Fit Tolerances			Shaft		Hub		
				Nominal Size	Shaft	Hub	Nominal Size, Hs	Tolerance	Nominal Size, Hh	Tolerance	
6	8	2	2	2	-0.004 -0.029	+0.0125 -0.0125	1.2	+0.1 0	1	+0.1 0	0.08 - 0.16
8	10	3	3	3	-0.004 -0.029	+0.0125 -0.0125	1.8	+0.1 0	1.4	+0.1 0	0.08 - 0.16
10	12	4	4	4	0 -0.030	+0.0150 -0.0150	2.5	+0.1 0	1.8	+0.1 0	0.08 - 0.16
12	17	5	5	5	0 -0.030	+0.0150 -0.0150	3	+0.1 0	2.8	+0.1 0	0.16 - 0.25
17	22	6	6	6	0 -0.030	+0.0150 -0.0150	3.5	+0.1 0	2.8	+0.1 0	0.16 - 0.25
22	30	8	7	8	0 -0.036	+0.0180 -0.0180	4	+0.2 0	3.3	+0.1 0	0.16 - 0.25
30	38	10	8	10	0 -0.036	+0.0180 -0.0180	5	+0.2 0	3.3	+0.2 0	0.25 - 0.40
38	44	12	8	12	0 -0.043	+0.0215 -0.0215	5	+0.2 0	3.3	+0.2 0	0.25 - 0.40
44	50	14	9	14	0 -0.043	+0.0215 -0.0215	5.5	+0.2 0	3.8	+0.2 0	0.25 - 0.40
50	58	16	10	16	0 -0.043	+0.0215 -0.0215	6	+0.2 0	4.3	+0.2 0	0.25 - 0.40
58	65	18	11	18	0 -0.043	+0.0215 -0.0215	7	+0.2 0	4.4	+0.2 0	0.25 - 0.40
65	75	20	12	20	0 -0.052	+0.026 -0.026	7.5	+0.2 0	4.9	+0.2 0	0.40 - 0.60
75	85	22	14	22	0 -0.052	+0.026 -0.026	9	+0.2 0	5.4	+0.2 0	0.40 - 0.60
85	95	25	14	25	0 -0.052	+0.026 -0.026	9	+0.2 0	5.4	+0.2 0	0.40 - 0.60
95	110	28	16	28	0 -0.052	+0.026 -0.026	10	+0.2 0	6.4	+0.2 0	0.40 - 0.60
110	130	32	18	32	0 -0.062	+0.031 -0.031	11	+0.2 0	7.4	+0.2 0	0.40 - 0.60
130	150	36	20	36	0 -0.062	+0.031 -0.031	12	+0.3 0	8.4	+0.3 0	0.70 - 1.0
150	170	40	22	40	0 -0.062	+0.031 -0.031	13	+0.3 0	9.4	+0.3 0	0.70 - 1.0
170	200	45	25	45	0 -0.062	+0.031 -0.031	15	+0.3 0	10.4	+0.3 0	0.70 - 1.0
200	230	50	28	50	0 -0.062	+0.031 -0.031	17	+0.3 0	11.4	+0.3 0	0.70 - 1.0
230	260	56	32	56	0 -0.074	+0.037 -0.037	20	+0.3 0	12.4	+0.3 0	1.2 - 1.6
260	290	63	32	63	0 -0.074	+0.037 -0.037	20	+0.3 0	12.4	+0.3 0	1.2 - 1.6
290	330	70	36	70	0 -0.074	+0.037 -0.037	22	+0.3 0	14.4	+0.3 0	1.2 - 1.6
330	380	80	40	80	0 -0.074	+0.037 -0.037	25	+0.3 0	15.4	+0.3 0	2.0 - 2.5
380	440	90	45	90	0 -0.087	+0.0435 -0.0435	28	+0.3 0	17.4	+0.3 0	2.0 - 2.5
440	500	100	50	100	0 -0.087	+0.0435 -0.0435	31	+0.3 0	19.5	+0.3 0	2.0 - 2.5

Notes:

- Make sure to consider the stress concentrations around the keyway.
- Key Hardness:
 - Standard: min. 183HV
 - Hardened: 390-510 HV
- Key length should be kept to less than 10 times the key width to minimize problems from poor key straightness.
- If more key length is needed then multiple keys may be used to carry greater load. They are normally placed 90 degrees apart. (Shigley's 9th ed)

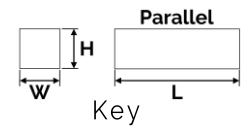
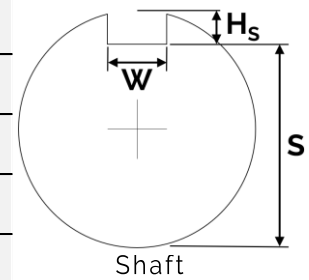
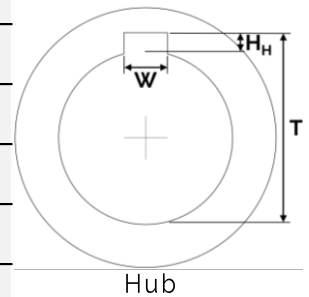

All dimensions in millimeters.

This document is provided for reference only and not intended to represent the best or only approach to any particular issue. Drawing Navigator, LLC does not make any guarantee with regard to the accuracy, completeness, or suitability of any document, and they assume no responsibility or liability in connection with the use or misuse of any material.